

DIFFUSER - R D 3

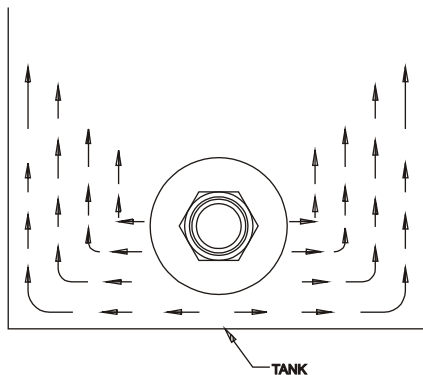

- USED IN RETURN LINE
- REDUCES DISCHARGE VELOCITY IN TWO STAGES
- MINIMISES TURBULENCE AND FOAMING
- THEREBY REDUCES AERATION / NOISE LEVEL
- MUST BE BELOW OIL LEVEL
- CAN ELIMINATE BAFFLE PLATE IN TANK
- CONSULT FACTORY FOR OPTIONAL ALL STEEL CONSTRUCTION

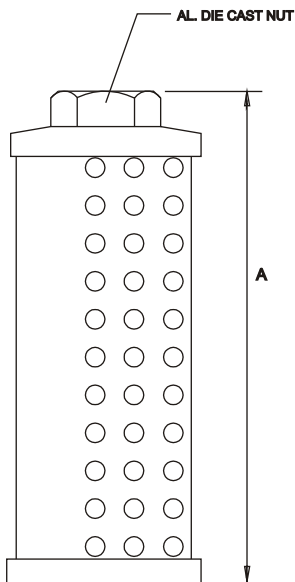
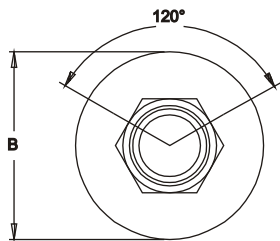

| MODEL | PORT IN. BSPP | A | B | RATED CAPACITY LPM | WT KGS |
|-----------|------------------|-----|-----|--------------------------|-----------|
| RD3 - 050 | 3/4" | 120 | 64 | 50 | 0.34 |
| RD3 - 100 | 1" | 125 | 86 | 100 | 0.38 |
| RD3 - 200 | 1 - 1/4" | 160 | 86 | 200 | 0.50 |
| RD3 - 300 | 1 - 1/2" | 190 | 86 | 300 | 0.70 |
| RD3 - 400 | 2" | 190 | 100 | 400 | 0.80 |
| RD3 - 500 | 2 - 1/2" | 200 | 150 | 500 | 0.90 |
| RD3 - 600 | 3" | 250 | 150 | 600 | 1.00 |

MODEL CODE

| R D 3 | 050 | * |
|---------------|---------------|-----------------------------------|
| SERIES | FLOW | THREADS |
| | | OPTIONAL # |
| RD3 | 050 - 50 LPM | B - BSPP (STD) N - NPT |
| | 100 - 100 LPM | |
| | 200 - 200 LPM | |
| | 300 - 300 LPM | |
| | 400 - 400 LPM | |
| | 500 - 500 LPM | |
| 600 - 600 LPM | | |

OPTIONAL / SPECIAL FEATURE - OMIT IF NOT REQUIRED