



Applications

Mobile equipment , agriculture machine and universal industrial equipment.

Features

- ◆ New valve design, it can resist damage from high flow and the pressure of impulse that providing advanced performance.
- ◆ Machined from solid steel barstock for durability.
- ◆ The KZE-BA Series employs a threaded sleeve locking mechanism, mates with matching male threads on the nipple. The two halves must be manually threaded together for connection.
- ◆ New chrome plating treatment provides advanced anti-rust performance.
- ◆ A threaded valve retainer provides a valve stop that assures positive valve alignment.
- ◆ Compatible with GROMELLE 6000 Series and HOLMBURY TGW Series

Specifications

Body Size(in)	1/4	3/8	1/2	3/4	1
Rated Pressure(PSI)	10000	10000	10000	8500	6000
Rated Flow(GPM)	3	6	12	28	50
Temperature Range(std seals)	-20°C to +100°C				
Standard seal material is Nitrile					

Performance

KZE-BA Series
(1/4" , 3/8" , 1/2" , 3/4" , 1")
Test Fluid: Oil-200SUS

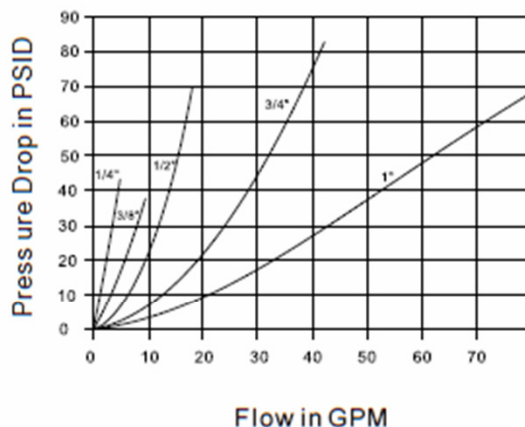

1 GPM=3.78 L/Min
1PSID=0.0069 Mpa

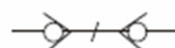

Socket

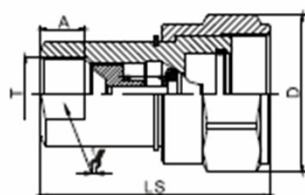

PART NO.	LS	D	$\frac{1}{2}$	A	T
KZE-BA-02SF	58.9	32	19	13	G1/4 NPT1/4
KZE-BA-03SF	66.5	36	22	16	G3/8 NPT3/8
KZE-BA-04SF	76.5	39	27	18	G1/2 NPT1/2
KZE-BA-06SF	89.5	50	35	20.5	G3/4 NPT3/4
KZE-BA-08SF	105.5	65	41	20.5	G1 NPT1

Plug

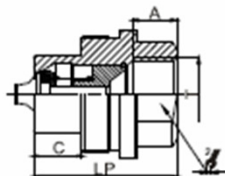

PART NO.	LP	C	$\frac{1}{2}$	A	T
KZE-BA-02PF	36	12.5	19	13	G1/4 NPT1/4
KZE-BA-03PF	40.5	16	22	16	G3/8 NPT3/8
KZE-BA-04PF	49	17	27	18	G1/2 NPT1/2
KZE-BA-06PF	56	19	35	20.5	G3/4 NPT3/4
KZE-BA-08PF	66	22	41	20.5	G1 NPT1

Coupling Fitting

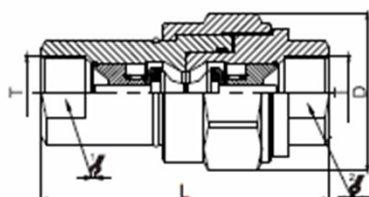

PART NO.	L	D	$\frac{1}{2}$	$\frac{3}{4}$	T
KZE-BA-02	72.3	32	19	19	G1/4 NPT1/4
KZE-BA-03	81.5	36	22	22	G3/8 NPT3/8
KZE-BA-04	98.3	39	27	27	G1/2 NPT1/2
KZE-BA-06	112.4	50	35	35	G3/4 NPT3/4
KZE-BA-08	132.9	65	41	41	G1 NPT1