

Dimensions

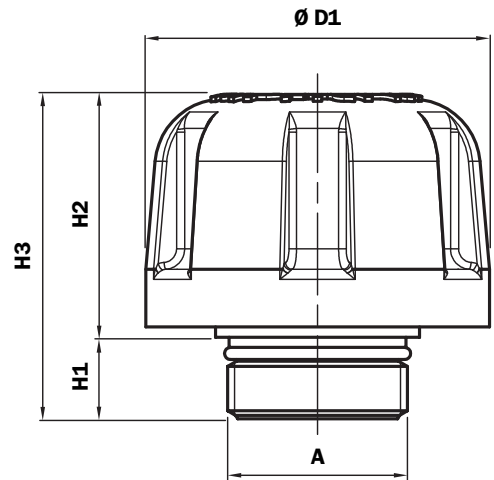
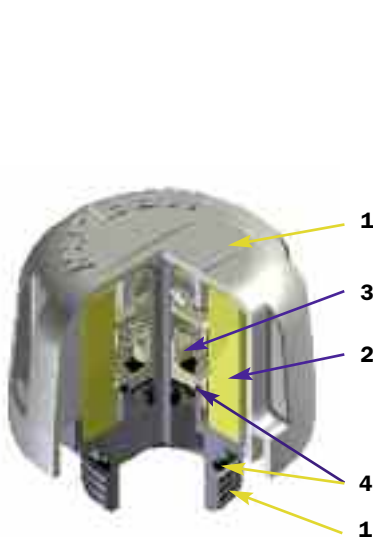

SAP050 (Materials)

- 1 - Cover/Connection: Nylon
- 2 - Filter element: Impregnated paper
Polyurethane
- 3 - Pressurisation: Nylon
Galvanised steel
NBR
- 4 - Seal: NBR

Flow rate with Δp : 0,02 bar

Filtration	I_N /min
10 μm	204

Weights

SAP 050: 0,040 kg

Connection to reservoir "A"

Type SAP 50				
G1	G2	G3	G4	G5
G 1/4"	G 3/8"	G 1/2"	G 3/4"	1/4" NPT
G6	G7	G8	G9	G10
3/8" NPT	1/2" NPT	3/4" NPT	SAE 6	SAE 12

Quantity per pack Number of Parts

SAP50	10
-------	----

Dimensions

Type SAP	D1	H1	H2	H3
50 G1				
50 G2				
50 G3				
50 G4	50,5	12	36	48
50 G5				
50 G6				
50 G7				
50 G8				
50 G9	50,5	14,5	35	50
50 G10				

Ordering information

Breather filter	1	2	3	4	5
SAP	<input type="checkbox"/>	<input type="checkbox"/>	<input type="checkbox"/>	<input type="checkbox"/>	<input type="checkbox"/>
Example: SAP50	G4	L10	A	0	P01

1 - Connection to reservoir

G1	G 1/4"
G2	G 3/8"
G3	G 1/2"
G4	G 3/4"
G5	1/4" NPT
G6	3/8" NPT
G7	1/2" NPT
G8	3/4" NPT
G9	SAE 6
G10	SAE 12

2 - Filter element

L03	3 μm - Impregnated paper
L10	10 μm - Polyurethane

3 - Seal

A	NBR
---	-----

4 - Pressurisation valve

0	Without
1	Pressurisation valve 0,5 bar Only for connection: G2 - G3 - G4 - G6 G7 - G8 - G10

5 - Options

P01	MP Filtri standard
-----	--------------------

Dimensions

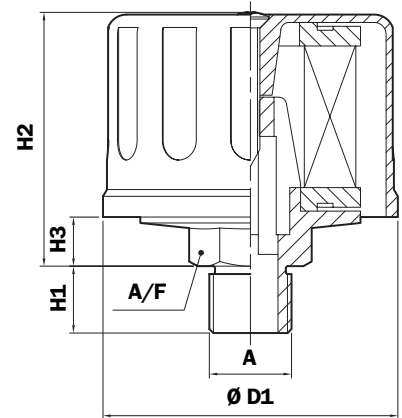

SAP 054 - 075 (Materials)

- 1 - Cover: Nylon
- 2 - Connection: Nylon
- 3 - Filter element: Impregnated paper

Weights

SAP 054: 0,060 Kg
SAP 075: 0,150 Kg

Flow rate with Δp : 0,02 bar

Filtration	I_N /min
SAP 054	
3 μ m	200
10 μ m	250
SAP 075	
3 μ m	350
10 μ m	400

Connection to reservoir " A "

Type SAP	G1	G2	G3	G4	G5
054	G 3/8"	G 1/2"	-	1/2" NPT	-
075	G 1/2"	G 3/4"	-	1/2" NPT	3/4" NPT

Dimensions

Type SAP	D1	H1	H2	H3	A/F (mm)
054 G1	54	13,5	51	8	22
054 G2					27
054 G4					
075 G1	75	17	64	9	32
075 G2					27
075 G4					
075 G5					

Ordering information

Breather filter

SAP

Example: SAP

1	2	3	4	5
<input type="checkbox"/>	<input type="checkbox"/>	<input type="checkbox"/>	<input type="checkbox"/>	<input type="checkbox"/>
075	G4	L10	A	P01

Filter element

Example:

1	3
<input type="checkbox"/>	<input type="checkbox"/>
A7	L10

1 - Size

Filter

054
075

Filter element

A4
A7

2 - Connection to reservoir

	SAP 054	SAP 075
G1	G 3/8"	G 1/2"
G2	G1/2"	G 3/4"
G3	-	-
G4	1/2" NPT	1/2" NPT
G5	-	3/4" NPT

3 - Filter element

L03	3 μ m - Impregnated paper
L10	10 μ m - Impregnated paper

4 - Seal

A	NBR
----------	-----

5 - Options

P01	MP Filtri standard
------------	--------------------

Series SAP 115

Nylon air breather filter



Clogging indicator
Set pressure: - 0.062 bar ± 10%
Manual reset

- SAP115 (Materials)**
- 1 - Cover: Nylon
 - 2 - Filter element: Microfibre
Impregnated paper
 - 3 - Connection: Nylon
 - 4 - Seals: NBR
FPM

Weight
 SAP 115 1: 0,410 Kg
 SAP 115 2: 0,525 Kg

Dimensions

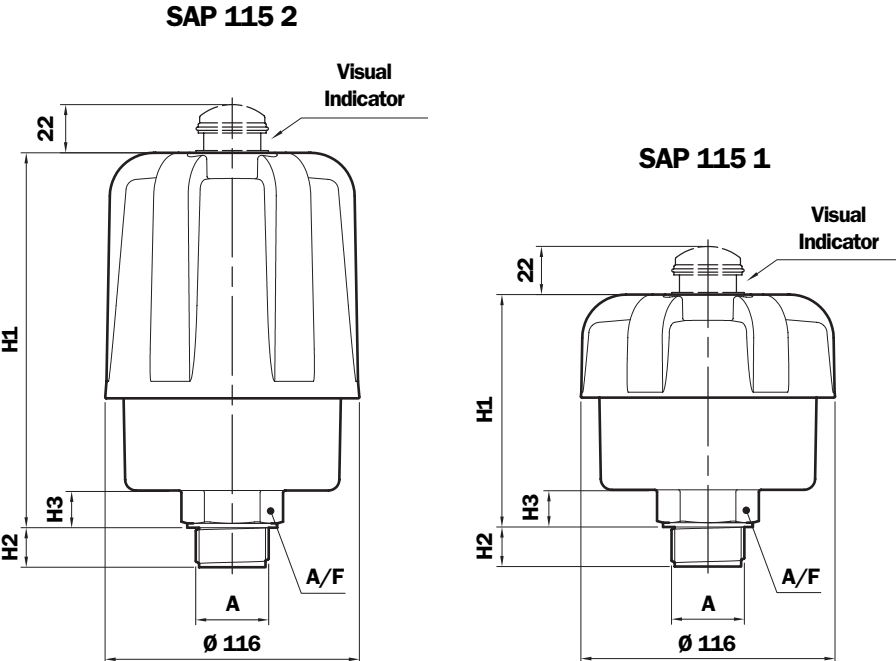

SAP 115 1 - Dimension

Connection	A	A/F	H1	H2	H3
A	G 1"	41	106	18	17
B	M33x2	41	106	18	17
C	G 1 1/2"	55	111	23	22

SAP 115 2 - Dimension

Connection	A	A/F	H1	H2	H3
A	G 1"	41	171	18	17
B	M33x2	41	171	18	17
C	G 1 1/2"	55	176	23	22

Flow rate with Δp: 0,02 bar

Connection	Filtration	l _v /min	
		SAP 115 1	SAP 115 2
G 1" M33x2	L10	2170	2800
	A03	1830	2800
G 1 1/2"	L10	2330	3000
	A03	1995	3000

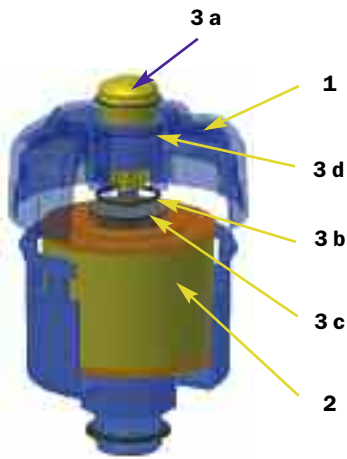

TAP SAP 115 spare parts

Item.	Description	Q.ty	Filler cap series SAP 115	
1	Complete filler cap	1	See order table	
2	Filter Element	1	See order table	
3	Indicator kit	1	NBR 02005187	FPM 02005188
3a	Visual indicator	1	S62P01	
3b	Seal	1	O-R 3106 Ø 26,64 X 2,62	
3c	Indicator securing screw	1	01022670	
3d	O-R indicator	1	O-R 2112 Ø 28,3 x 1,78	

Changing the filter element in SAP 115 series filler caps

- 1 Thoroughly clean the filler cap and adjacent parts.
- 2 Unscrew and raise the cover.
- 3 Replace the filter element.
- 4 Screw the cover.



Ordering information

Breather filter
SAP115
Example: SAP115

1	2	3	4	5	6	7
<input type="checkbox"/>	<input type="checkbox"/>	<input type="checkbox"/>	<input type="checkbox"/>	<input type="checkbox"/>	<input type="checkbox"/>	<input type="checkbox"/>
2	A	A03	A	1	B	P01

Filter element
A115
Example: A115

1	3	7
<input type="checkbox"/>	<input type="checkbox"/>	<input type="checkbox"/>
2	A03	P01

1 - Length

1
2

2 - Connection

<input type="checkbox"/>	G 1"
<input type="checkbox"/>	M33x2
<input type="checkbox"/>	G 1 1/2"

3 - Filter element

<input type="checkbox"/>	3 µm - Microfibre
<input type="checkbox"/>	10 µm - Impregnated paper

4 - Seal

<input type="checkbox"/>	NBR
<input type="checkbox"/>	FPM

5 - Variants

<input type="checkbox"/>	Standard
<input type="checkbox"/>	With anti-splash feature

6 - Clogging indicator

<input type="checkbox"/>	Without
<input type="checkbox"/>	Visual indicator

7 - Options

<input type="checkbox"/>	MP Filtri standard
--------------------------	--------------------